



SAF-HOLLAND Group

HOLLAND FWAL-E SERIES

NEW

LIGHT WEIGHT
ALUMINIUM
TECHNOLOGY
PROVIDES UP TO
33 KG WEIGHT
SAVING



THE WORLD'S LIGHTEST 20 TON FIFTH WHEEL.

SAF-HOLLAND (the world's leader in fifth wheel technology) and Alcoa (the world leader in aluminium technology) have partnered to produce the first commercially available aluminium fifth wheel.

- **Lightest weight standard-duty fifth wheel available anywhere.** Up to 33 kg lighter than competitive fifth wheels.
- **Maximum Vertical Load:** 20,000 kg.
- **True **NoLube**® Technology.** Uses the only technology that requires no fifth wheel lubrication, including the lock.
- **5 Year/800,000 km Performance Guarantee.***

Simply put:

- No bracket pocket insert replacements
- No lock jaw replacements
- No rebuilds
- **2 Year/200,000 km Lube Plate Warranty.***

*In accordance with SAF-HOLLAND warranty conditions

BETTER FOR YOUR BOTTOM LINE

Tractors keep getting heavier and weight can be critical to the profitability of a fleet. 33 kg less fifth wheel weight means 33 kg more load per trip and that means more profit per trip. In addition, true NoLube® technology reduces maintenance time and costs.

BETTER FOR THE ENVIRONMENT

True NoLube® technology means your drivers and maintenance staff can work faster and safer in a cleaner environment. More importantly, eliminating the use of grease is an environmentally conscious and responsible choice.



SAF-HOLLAND Group

FWAL-E SERIES FORGED ALUMINIUM TECHNOLOGY

CAPACITY:

20,000 kg Maximum Vertical Load
150 kN D-Value
EC type approval number
e11*94/20*6168

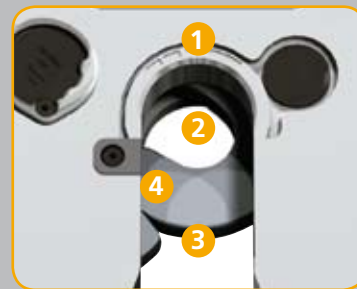

1 High Coupling Protection.

Lock system protects against coupling at an improper height.

2 Much greater King Pin-to-Lock Contact Area,

compared to competitive models, for longer kingpin and lock life.

3 Forged/Cast Steel Locks.

Rear lock is forged, hardened and machined steel. Front lock is machined and hardened, wear-resistant alloy.

4 NoLube® Technology.

Components are protected with a low-friction coating which provides long wear life and corrosion protection eliminating the need for lubrication.

Front lock insert is machined and hardened, wear-resistant alloy.

Ergonomic release handle fully complies with the interlocking requirements of EC 94/20 and features SAF-HOLLAND's easy-to-pull, one-hand operation "trigger lock".

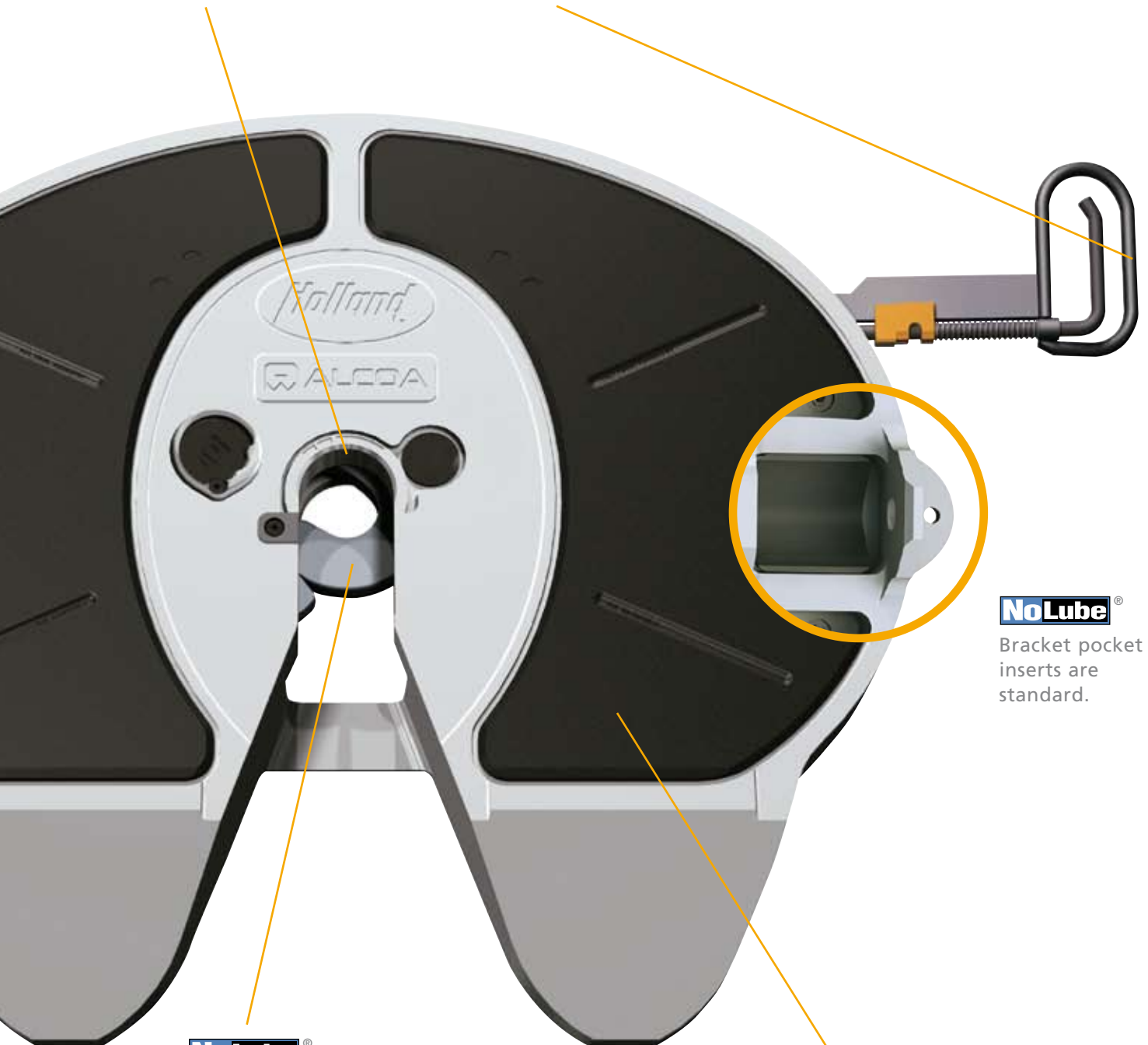

NoLube[®]

Bracket pocket inserts are standard.

NoLube[®]

The forged and hardened coupler jaw is protected with an advanced surface coating alloy for extreme wear resistance, optimising life expectancy and eliminating the need for lubrication.

NoLube[®]

Replaceable lube plate inserts are made with UHMW (Ultra-High Molecular Weight) polyethylene molded to a "perforated" steel reinforcement plate. This design makes the lube plates highly resistant to peeling and damage. The low friction lube plates fit into cast recesses of the top plate and are secured by studs and lock nuts.



Lock adjustment system makes the adjustment process simple and easily accessible.

Forged aluminium top plate manufactured by Alcoa from the same alloy as their aluminium truck wheels (6061-T6), providing the perfect combination of the lightest 20 ton fifth wheel in the world with strength and durability.

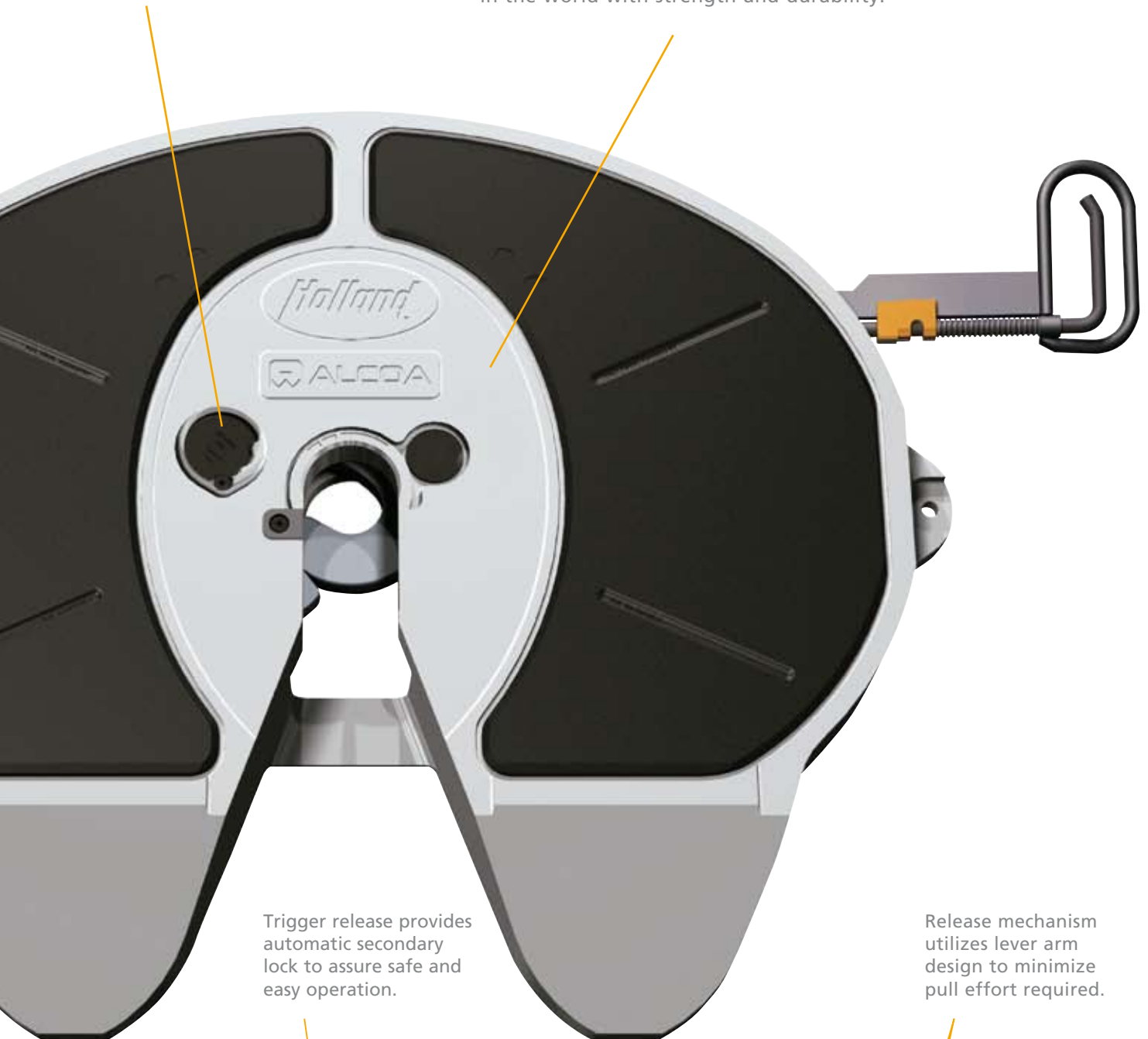

Trigger release provides automatic secondary lock to assure safe and easy operation.

Release mechanism utilizes lever arm design to minimize pull effort required.



FWAL-E MOUNTING OPTIONS

ISO BRACKET MOUNTING



International Standard ISO/DIN 6 hole mounting bracket offering full interchangeability with fifth wheel worldwide, strong cast construction for maximum durability. Type approved to EC 94/20 regulations.

Part Number	Height	Weight
FWAL-E-IS-165	167 mm	94 kg
FWAL-E-IS-195	197 mm	100 kg
FWAL-E-IS-220	219 mm	103 kg

WEIGHTSAVER MOUNTING



Combined mounting brackets and mounting plate resulting in weight reduction with easier and time-saving installation through direct mounting on the chassis. Manufactured in accordance with EC 94/20 and having full EC type approval.

Available in 2 different widths and available with hole patterns to suit all OEM chassis mounting angles.

Contact SAF-HOLLAND for full part number information.

Part Number	Height	Weight
FWAL-E-W1-155	156 mm	117 kg
FWAL-E-W1-180	180 mm	120 kg
FWAL-E-W1-205	205 mm	123 kg
FWAL-E-W1-245	243 mm	127 kg

Part Number	Height	Weight
FWAL-E-W2-155	156 mm	121 kg
FWAL-E-W2-180	180 mm	124 kg
FWAL-E-W2-205	205 mm	127 kg
FWAL-E-W2-245	243 mm	131 kg

ILS SLIDER MOUNTING



Integrated Lightweight Sliding fifth wheel, saving up to 58 kg on competitors products. Air release standard on all models.

Fifth wheel position adjustable in 50 mm increments.

Available pre-drilled for bolting directly to all OEM tractor unit mounting angles.

Contact SAF-HOLLAND for full part number information.

Weight from 195 kg complete with top plate (FWAL-12D).

Part number guide for complete sliding fifth wheel assemblies:

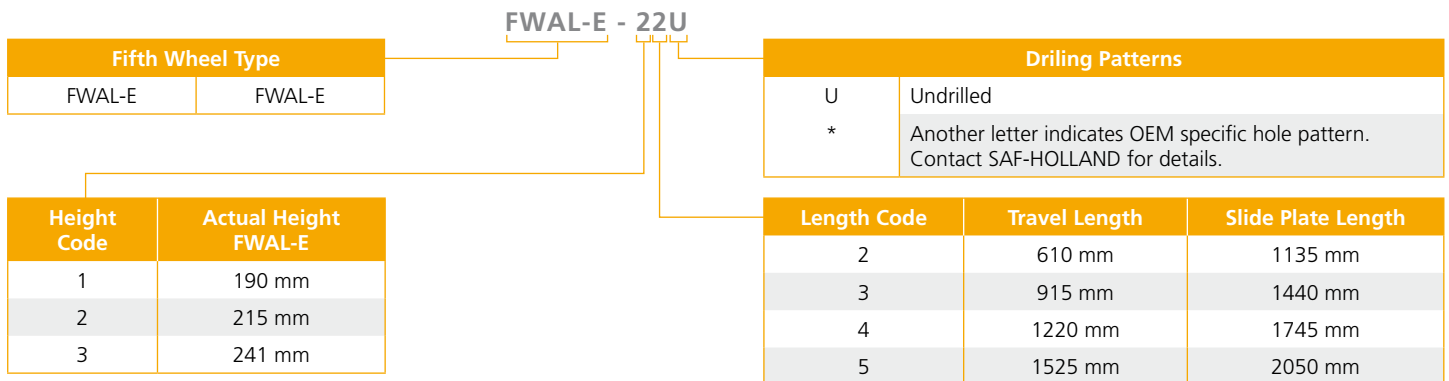

LESS WEIGHT FOR YOUR TRAILER – MORE PROFIT FOR YOUR BUSINESS

Example:

Fuel haulier will exceed maximum weight limit before reaching volume capacity of tanker.

Potential:

For every 0,83 kg saved another litre of fuel can be delivered
33 kg savings = 40 litres more fuel every delivery.

Annual Savings:

5 trips/shift x 3 shifts/day x 365 days/year = 5,475 deliveries/year
5,475 x 40 = 219,000 litres more fuel per year!
At approx. € 0,02 profit per litre = approx. € 4,380 additional profit per year with the same number of journeys!

GCW = approx. 7,500 kg tractor
approx. 5,000 kg trailer
approx. 32,000 kg (ca. 38,000 l)
approx. 44,000 kg (maximum legal limit)

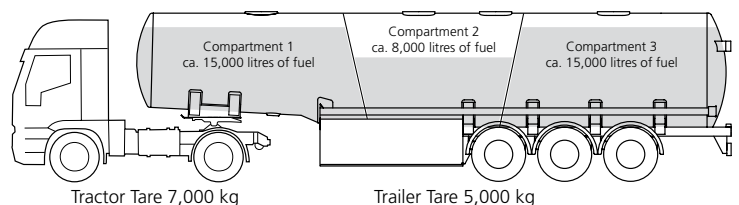



SAF's history begins in 1881 in a village forge in Germany with the invention of a new plough. The family business soon starts building steel axles for agricultural vehicles, and under the name Otto Sauer Achsenfabrik (SAF) develops into one of the leading manufacturers of trailer axles and suspension systems in Europe.

A safety coupling between plough and horse team can be found at the beginning of Holland's history. The Safety Release Clevis Company was founded in South Dakota, USA, in 1910. After its move to Holland, Michigan, the company emerges as one of the largest supplier companies to the commercial vehicles industry under the name The Holland Hitch Company.

The merger of the two companies to form SAF-HOLLAND in 2006 creates one of the leading global suppliers of high-quality components and services for the commercial vehicle industry. Alongside axle and suspension systems for trailers and semi-trailers, the product range also includes kingpins and landing gear as well as fifth wheels for tractors, air suspensions, coupling products and numerous other components for buses and trucks.

Today SAF-HOLLAND is represented on all continents and distributes its products and services worldwide under the brand names SAF and HOLLAND. It can boast of an extensive distribution network with global service and dealer locations.

HIGH QUALITY COMPONENTS FOR THE COMMERCIAL VEHICLE INDUSTRY



EUROPE · NORTH AMERICA · SOUTH AMERICA · AFRICA · ASIA · AUSTRALIA

SAF-HOLLAND GmbH

Hauptstraße 26 · 63856 Bessenbach · Germany · Tel +49 6095 301-0

www.safholland.com

